

|   |               |
|---|---------------|
| Company: ****   | Melway: 44 F9 |
| Location: Church St (Richmond)<br>near Bridge Rd          | Scale: NTS    |
| Municipality: Yarra City Council                          | Page: 1 of 1  |
| TMP Author: Joel MacKenzie                                | Revision: 02  |
| Type Of Works: Insertion works                            | Job No: N/A   |
| Created: 22/11/2016 Rev 28/11/2016                        |               |
| Filename: Church St & Bridge Rd (Richmond) Stage 1-01.pdf |               |

ONCE ALL SIGNAGE HAS BEEN INSTALLED, A DRIVE-THROUGH SHALL BE CONDUCTED. SIGNAGE MAY NEED TO BE RELOCATED FOR MAXIMUM VISIBILITY, IT MAY ALSO NEED TO BE RELOCATED FOR MAXIMUM EFFECTIVENESS. ALL TRAFFIC MANAGEMENT PLANS ARE COPYRIGHT / PROPERTY OF DALYS TRAFFIC AND IS NOT TRANSFERABLE UNLESS AUTHORISED BY DALYS TRAFFIC. THIS PLAN IS A GUIDE ONLY FOR TRAFFIC MANAGEMENT PURPOSES. DALYS TRAFFIC DOES NOT ACCEPT RESPONSIBILITY IF SET UP BY OTHERS. IMPLEMENTATION OF THE TRAFFIC GUIDANCE SCHEMES IN THE FIELD MUST BE MADE BY A TRAFFIC MANAGEMENT COMPANY THAT HAS BEEN PRE-QUALIFIED BY VICROADS.

## Stage 1 - Church St & Bridge Rd (Richmond)

**NOTE:**  
 TRAFFIC CONTROLLERS TO ASSIST PEDESTRIANS  
 & REMAIN ON SLOW  
 TO CREATE A SAFE WORK ENVIRONMENT

Bridge Rd 40km/h zone - between Punt & Burnley - 7am - 12pm  
 Replace 'End Road Work' with 'End Road Work 60' after 12:00pm



**NOTE:**  
 SPACING OF BOLLARDS:  
 LOW SPEED (ON STRAIGHT)  
 MAX. SPACING 12 - 15M (HIGH SPEED)  
 MAX. SPACING 4M (LOW SPEED)

MERGE TAPERS (9M)

LATERAL SHIFT MARKERS  
 MAX. SPACING 20 - 24M

A LANE WIDTH OF 3.2M (MINIMUM)  
 IS TO BE MAINTAINED

**PROJECT CONTACT:**  
 Name: \*\*\*  
 Mob: \*\*\*  
 Email: \*\*\*\*

**TRAFFIC MANAGEMENT CONTACT:**  
 Name: Mark Bradley  
 Mob: 0412 830 359

**PLAN AUTHOR:**  
 Name: Joel MacKenzie  
 Tel: 9399 9525

**EMERGENCY:**  
 AMBULANCE/POLICE/FIRE Tel: 000

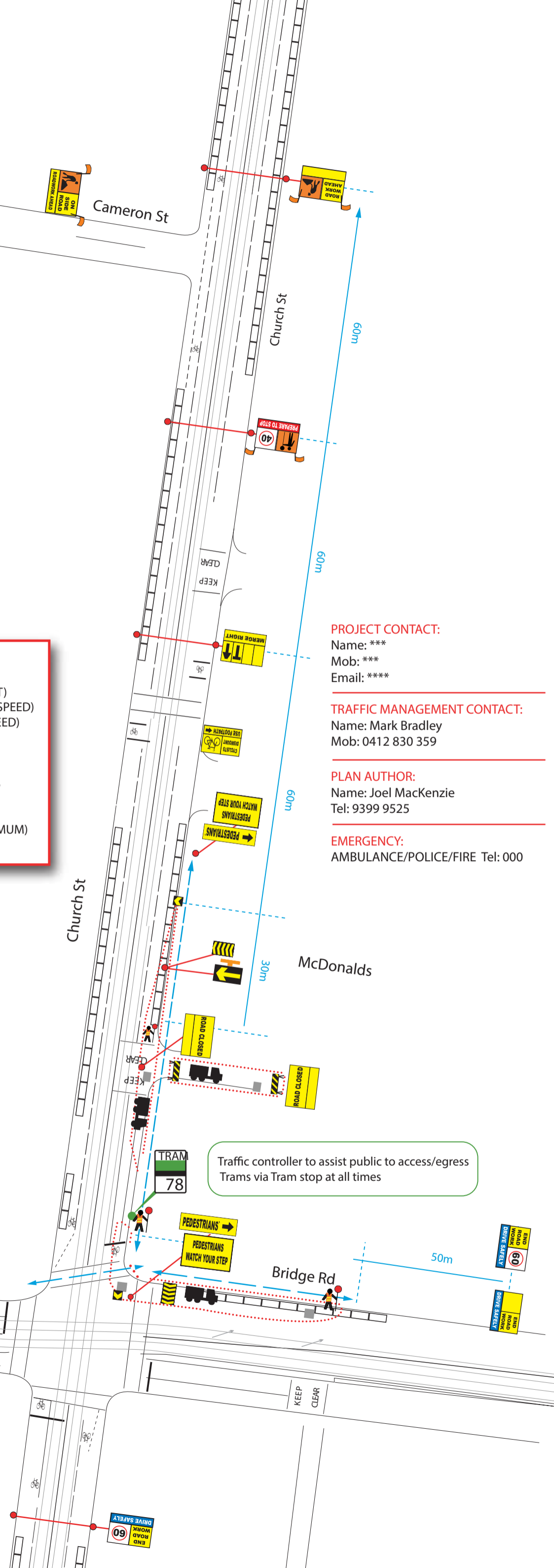

**PEDESTRIANS WATCH YOUR STEP**

**NOTE:**  
 'PEDESTRIANS WATCH YOUR STEP' SIGNAGE TO USED WHERE NEEDED.

**PEDESTRIANS**  
 (1.2m+ CLEARANCE)